





Summer 2024 Construction Campus Access Guide

LEGEND

-  Accessible Building Entry
-  Campus Map & INFORMATION
-  Handicapped Accessible Parking
-  Blue Security Phone
-  Vehicular Entry to Campus

Stairway & North side
walkway closed Jun. 10th-
July 5th

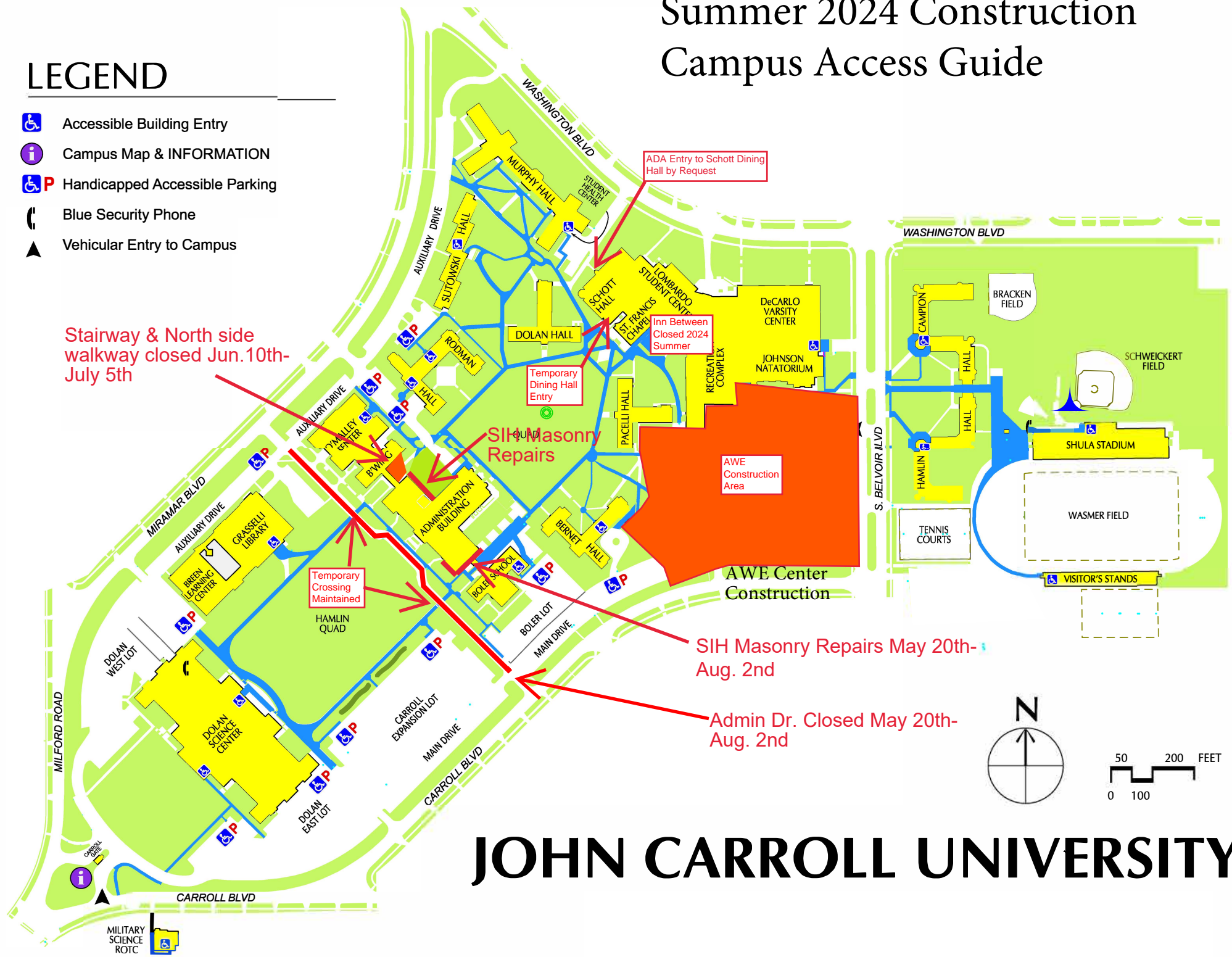

JOHN CARROLL UNIVERSITY

MILITARY SCIENCE ROTC

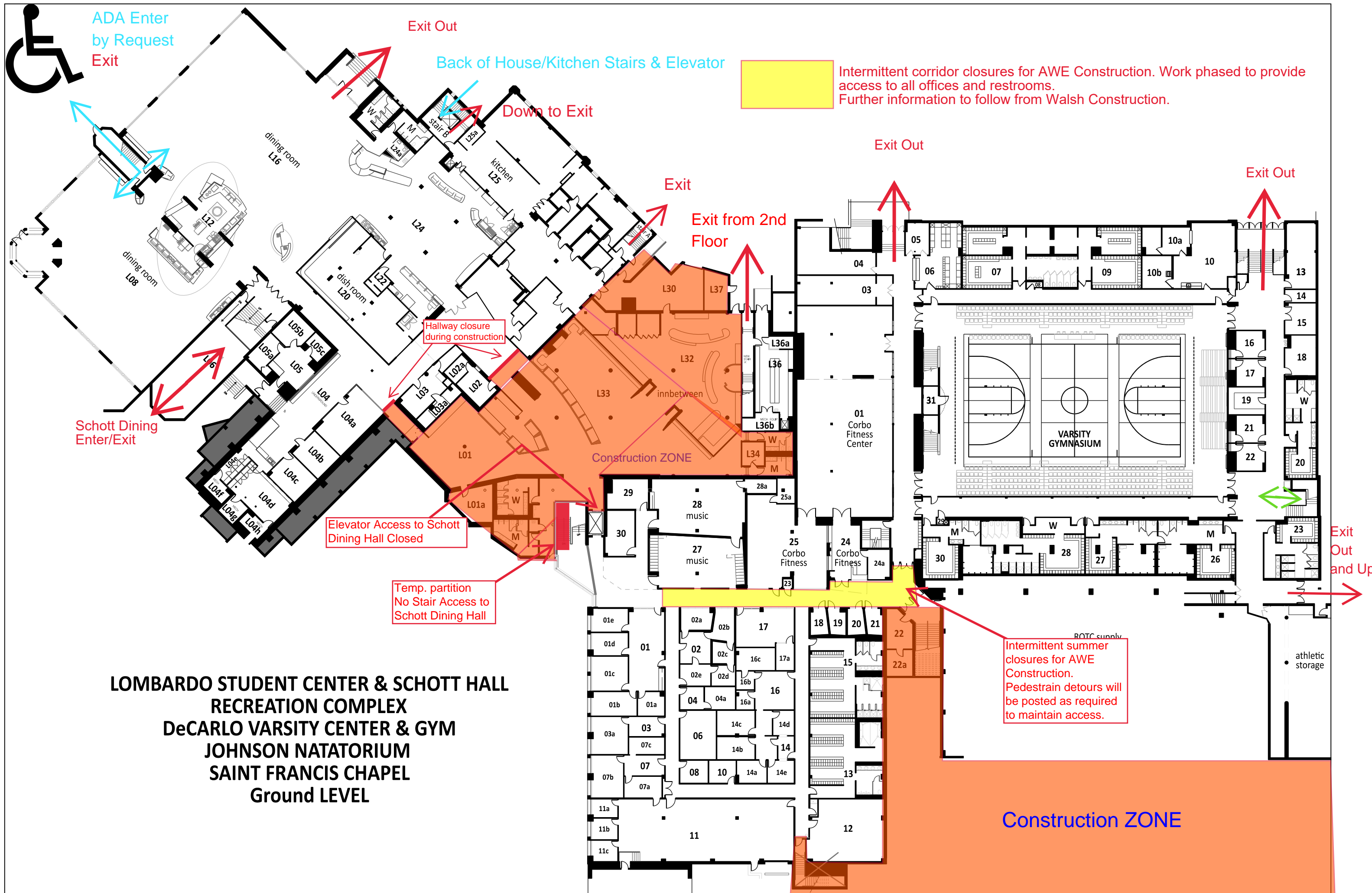

ADA Enter by Request Exit

Exit Out

Back of House/Kitchen Stairs & Elevator

Intermittent corridor closures for AWE Construction. Work phased to provide access to all offices and restrooms. Further information to follow from Walsh Construction.

Down to Exit

Exit Out

Exit Out

Exit

Exit from 2nd Floor

Hallway closure during construction

Schott Dining Enter/Exit

Elevator Access to Schott Dining Hall Closed

Temp. partition No Stair Access to Schott Dining Hall

Construction ZONE

Intermittent summer closures for AWE Construction. Pedestrian detours will be posted as required to maintain access.

Exit Out and Up

LOMBARDO STUDENT CENTER & SCHOTT HALL RECREATION COMPLEX
DeCARLO VARSITY CENTER & GYM
JOHNSON NATATORIUM
SAINT FRANCIS CHAPEL
Ground LEVEL

Construction ZONE



5-1-24 Walsh Construction to start Fitness Studio, Raquetball Court, and vacant offices. Intermittent corridor closures for AWE construction in June/July with further information communicated to Campus through Walsh Construction.



Enter/Exit to Schott Dining Hall for Summer 2024

Enter Exit ADA



Closure starting May 1st

Intermittent summer closures for AWE Construction. Pedestrian detours will be posted as required to maintain access.

Construction ZONE

LOMBARDO STUDENT CENTER & SCHOTT HALL RECREATION COMPLEX DeCARLO VARSITY CENTER & GYM JOHNSON NATATORIUM SAINT FRANCIS CHAPEL First LEVEL